

防爆荧光舱顶灯 EXPLOSION-PROOF FLUORESENT PENDANT LIGHT

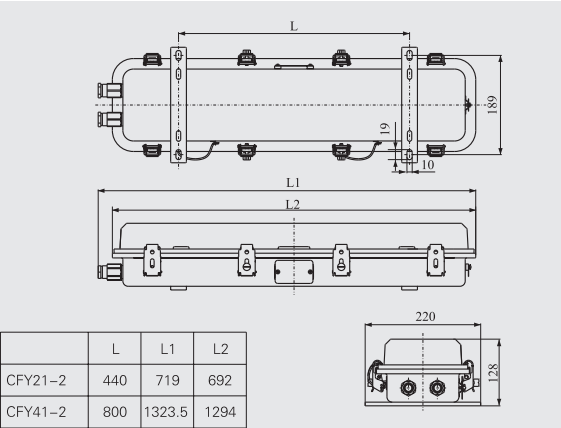

规格Specification:

型号 Type	防爆标志 Explosionproof mark	电压 Voltage	功率 Power	灯座 holder	电缆外径 Cable outside diameter	防护等级 Protection class	重量 Weight
CFY21-2	Exemd II C T5	220V/50Hz 220V/60Hz 110V/60Hz	2*20W	Fa6	φ 10- φ 12.5	IP56	5.5kg
CFY41-2			2*40W				9.5kg

适用范围:

适用于舰船、石油开采平台、化工及具有爆炸性气体的1区或2区场所照明。

产品特点:

- 1. 壳体采用优质钢模压成型，灯罩为优质透明PC注塑成型；
- 2. 整体式搭扣，密封性能良好，防护等级高；
- 3. 灯具采用快速防爆电子镇流器启动，启动效果好；
- 4. 防爆灯座Fa6；
- 5. 隔爆、增安、胶封型防爆结构。

采用标准:

符合国际IEC标准、GB19510.4、GB3836和GB12045标准相关要求。

The scope of application:

Applied to ship oil exploit platform, chemical product and explosiv gas place zone1 or zone 2.

Products charatceristic:

- 1. The shell is made of good quality steel, the lampshade is good quality transperance PC.
- 2. Intergral type clip, high protection grade.
- 3. The light adopt rapid ex-proof electronic ballast, with good starter effect.
- 4. Ex-proof lamp holder Fa6
- 5. Flameproof type, increased safety type and cementing type structure.

Adopt standard:

conform to international IEC standard, GB19510.4, GB3836 AND GB12045 standard relative requirement.

防爆荧光蓬顶灯EX-PROOF FLUORESCENT CEILING LIGHT

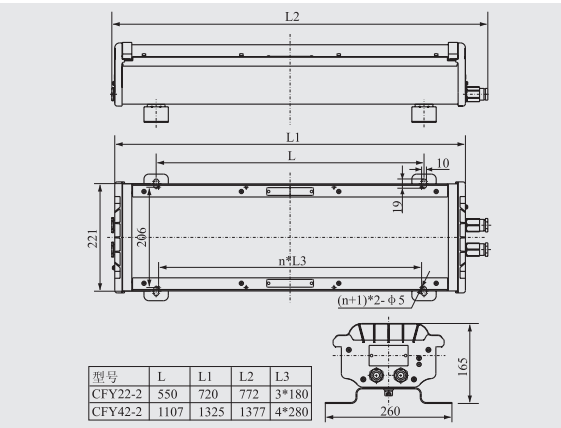
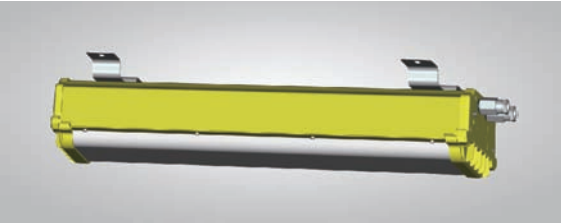

规格Specification:

型号 Type	防爆标志 Explosionproof mark	电压 Voltage	功率 Power	灯座 holder	电缆外径 Cable outside diameter	防护等级 Protection class	重量 Weight
CFY22-2	Exemd II C T5	220V/50Hz 220V/60Hz 110V/60Hz	2*20W	Fa6	φ 10- φ 12.5	IP54	6.8kg
CFY42-2			2*40W				14.8kg

适用范围:

适用于可能存在爆炸性气体环境的化工厂、炼油厂、油气库等危险场所及海洋石油平台舱室照明。

产品特点:

- 1. 壳体采用优质的铝合金挤压成型，灯罩为优质乳白色PC挤塑成型；
- 2. 灯具外部整体用内六角螺钉紧固，密封性能良好，防护等级高；
- 3. 灯具具有吸顶式安装和边框安装两种安装方式，用户可以方便选择；
- 4. 灯具采用快速防爆电子镇流器启动，启动效果好；
- 5. 隔爆、增安、胶封型防爆结构。

采用标准:

符合国际IEC标准、GB19510.4、GB3836和GB12045标准相关要求。

The scope of application:

Applied to illumination in the hazardous area such as Chemical Factory, oil refinery, oil and gas plant with explosive gas atmosphere, and offshore oil platforms

Products characteristic:

- 1. The shell is made of aluminum, and PC lampshade
- 2. The external of light is fixed by inner hexagon screw, has good seal performance and high protection class
- 3. The light has two mounting way, surface and flush mounting ,it is convenient for clientto choose
- 4. The light adopt the quick start ex-proof electronic ballast, it has good start effect
- 5. flameproof type, increased safety type and cementing type structure

Standard:

Conform to the relative request of international IEC standard, GB19510.4, GB3836 and GB12045 standard